

# SPOT ZERO®

## ZTCII CONFIGURATIONS

### ZTCII 2000

2000 GPD (7571 LPD) / 83 GPH (315 LPH)

115V AC P/N:9610001284

230V AC P/N:9610001169

LOCALLY MOUNTED

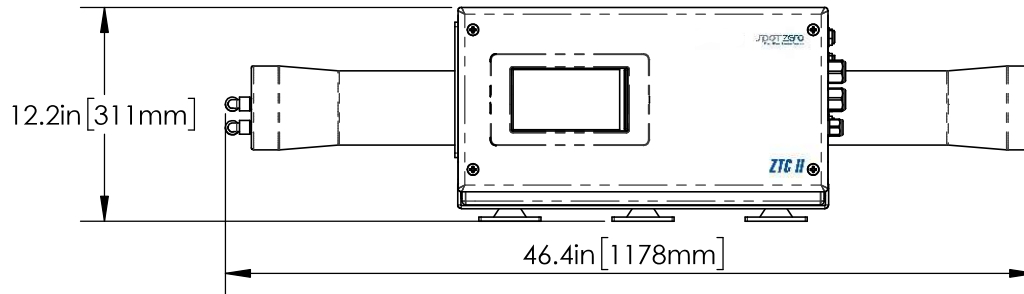

### ZTCII 2000

2000 GPD (7571 LPD) / 83 GPH (315 LPH)

115V AC P/N:9610001284

230V AC P/N:9610001169

REMOTE MOUNTED

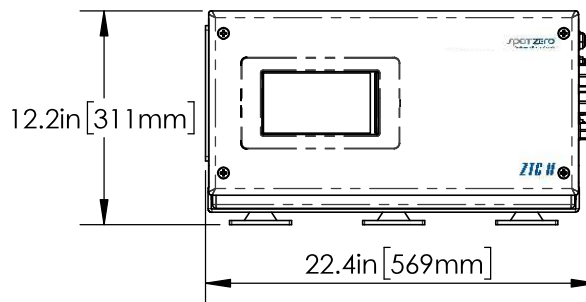
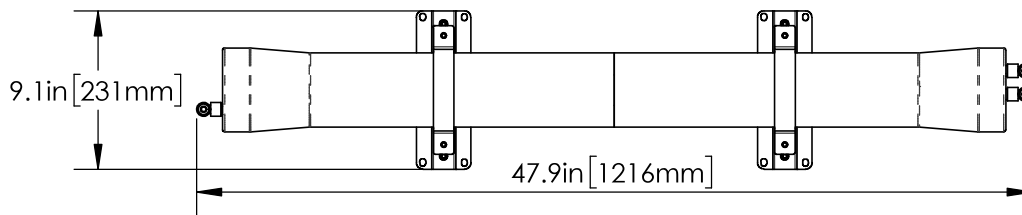

### ZTCII 3000

3000 GPD (11356 LPD) / 125 GPH (473 LPH)

115V AC P/N:9610002708

230V AC P/N:9610002709

REMOTE MOUNT ONLY

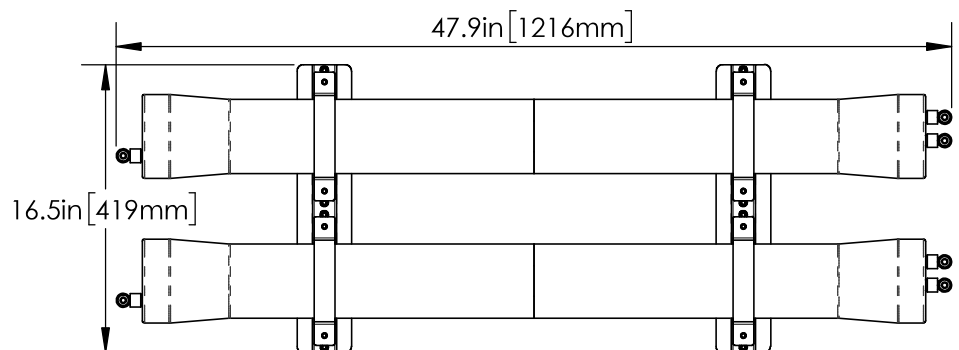
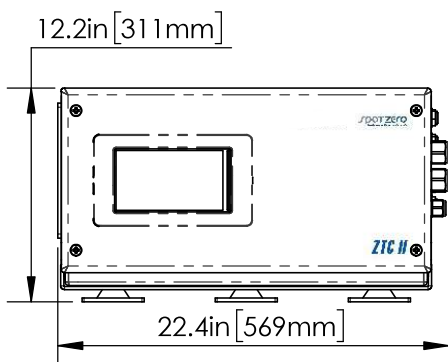

## STANDARD EQUIPMENT

### COMMERCIAL PRE-FILTER

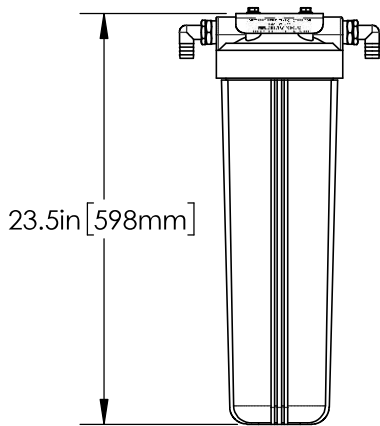
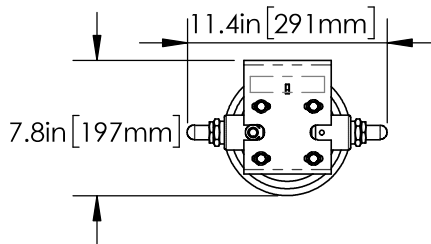

### BACTERIOSTATIC REMINERALIZER & pH NEUTRALIZER

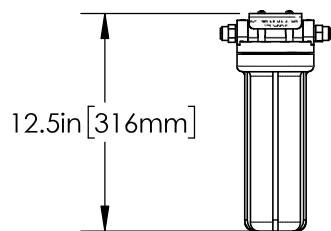
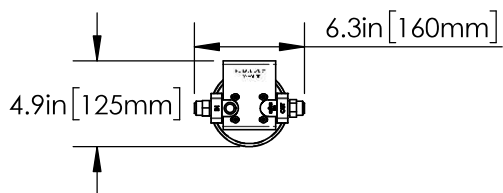

## OPTIONAL EQUIPMENT

### REMOTE MOUNT 7 -INCH TOUCHSCREEN

P/N:252404181

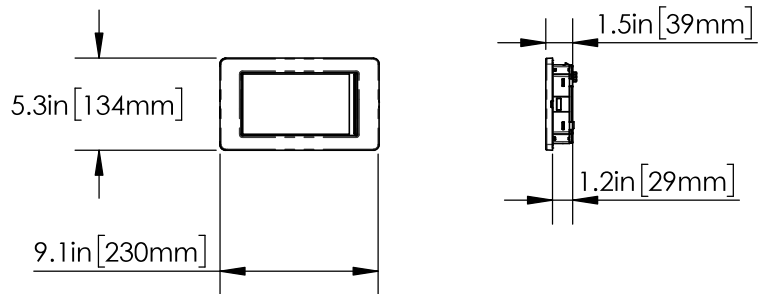

### SHORT PRE-FILTER

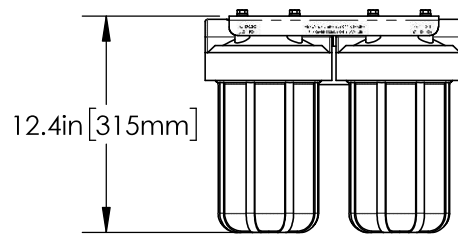
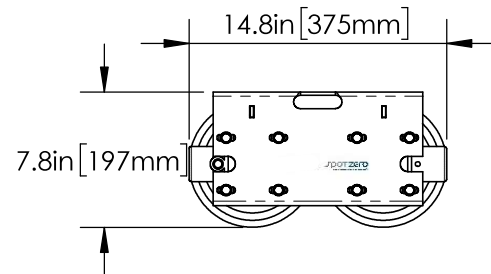

NOTE: NO UPCHARGE IF SPECIFIED WHEN PLACING ORDER

## SUPPLEMENTAL ZTCII DIMENSIONS

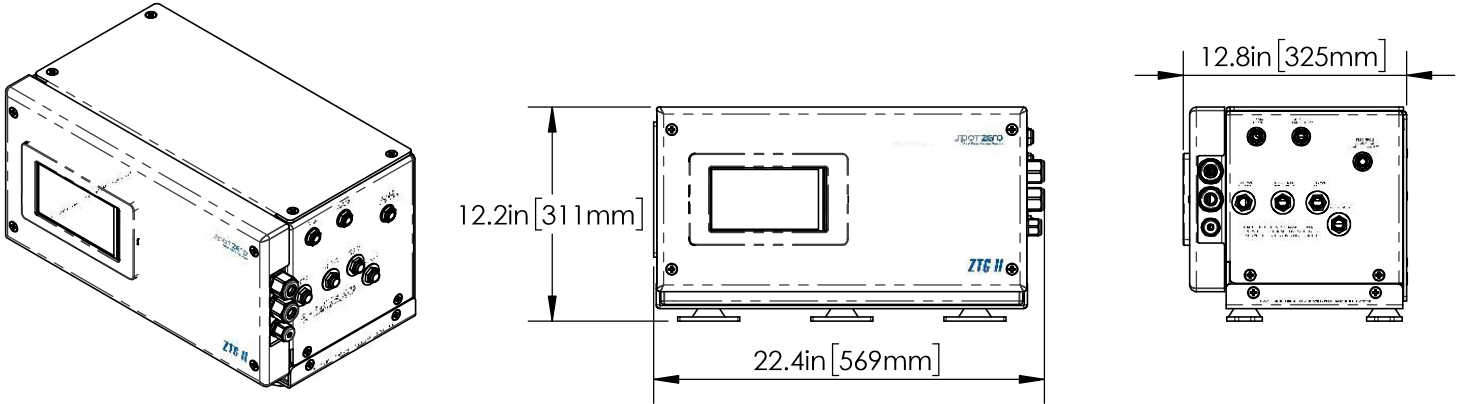

### ZTCII 2000 MEMBRANE VESSEL 2000 GPD (7571 LPD) / 83 GPH (315 LPH)

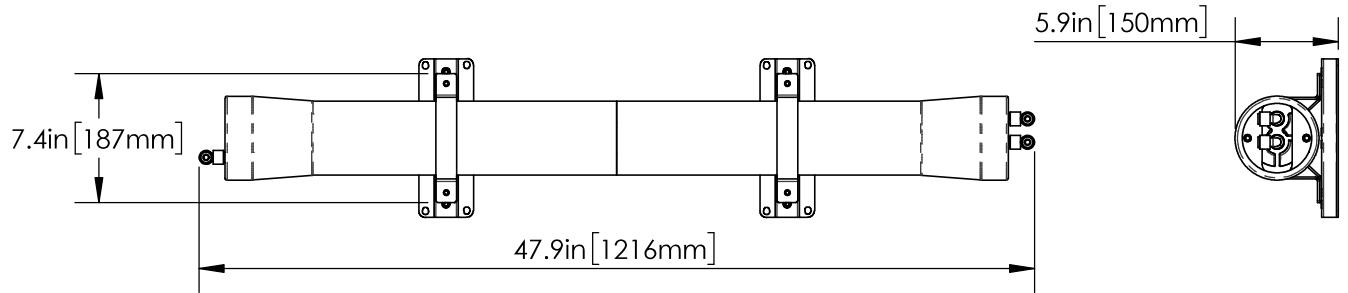

### ZTCII 3000 MEMBRANE VESSELS 3000 GPD (11356 LPD) / 125 GPH (473 LPH)

